

# 88 5558 83 Floral Blossom Chaise with Cushion

## IMPORTANT NOTE

Carefully remove all the parts from the carton and put them individually on a soft cloth to prevent scratches or other damages occurring to the parts.

We have taken great care in the design of this product and request that you carefully and strictly follow our assembly instructions to ensure a completed product as it was designed.

*Home  
Styles*

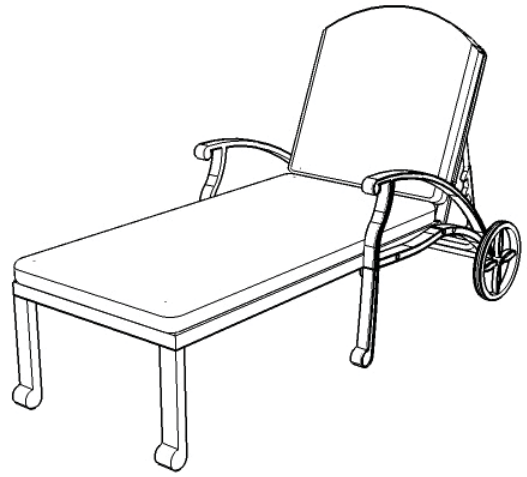

## Part List

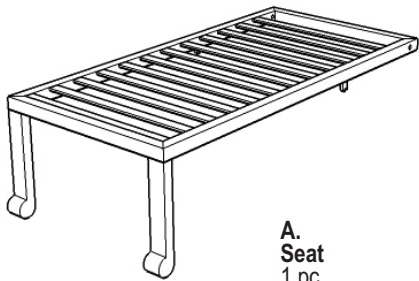

**A.**  
Seat  
1 pc.

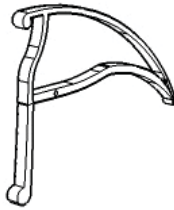

**B.**  
Arm  
1 pc.

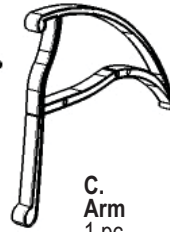

**C.**  
Arm  
1 pc.

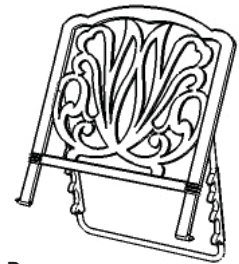

**D.**  
Back Frame  
1 pc.

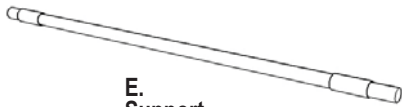

**E.**  
Support  
1 pc.



**G.**  
Wheel  
2 pcs.

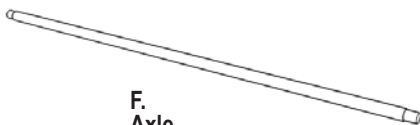

**F.**  
Axle  
1 pc.

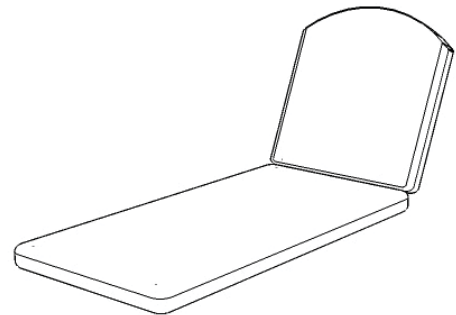

**H.**  
Cushion  
1 pc.

## Hardware List



**Key Wrench**  
1 pc.

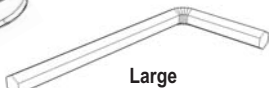

**Large Hex Wrench**  
1 pc.



**Nut**  
6 pcs.(+1 extra)



**Spring Washer**  
8 pcs.(+1 extra)

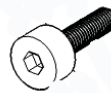

**Head Cap Bolt (large)**  
2 pcs.(+1 extra)



**Head Cap Bolt (long)**  
2 pcs.(+1 extra)



**Head Cap Bolt (short)**  
2 pcs.(+1 extra)



**Small Hex Wrench**  
1 pc.

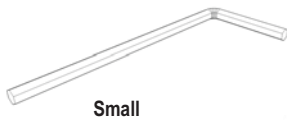

**Small Hex Wrench**  
1 pc.



**Bolt**  
6 pcs.(+1 extra)



**Flat Washer (small)**  
2 pcs.(+1 extra)



**Flat Washer**  
6 pcs.(+1 extra)



**Flat Washer (large)**  
2 pcs.(+1 extra)



**Nut Cap**  
6 pcs.(+1 extra)

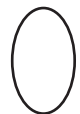

**Wheel Cap**  
2 pcs.(+1 extra)

**Tools required for assembly :** Slotted screwdriver

**Home Styles Consumer Assistance:** [www.homestyles-furniture.com](http://www.homestyles-furniture.com),  
[servicedesk@homestyles-furniture.com](mailto:servicedesk@homestyles-furniture.com), 888-680-7460, 877-831-0319

# Assembly Instructions 2/4

## IMPORTANT

\* Do not tighten up all the screws until each part is properly assembled.

\* You should keep Key Wrenches and Hex Wrench in a safe place as you may need to tighten up the Nuts and Head Cap Bolts in the future.

## STEP 1

Insert all Bolts into the pre-drilled holes of Arm (B) and (C).  
(See Figure 1)

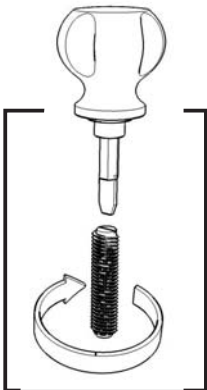
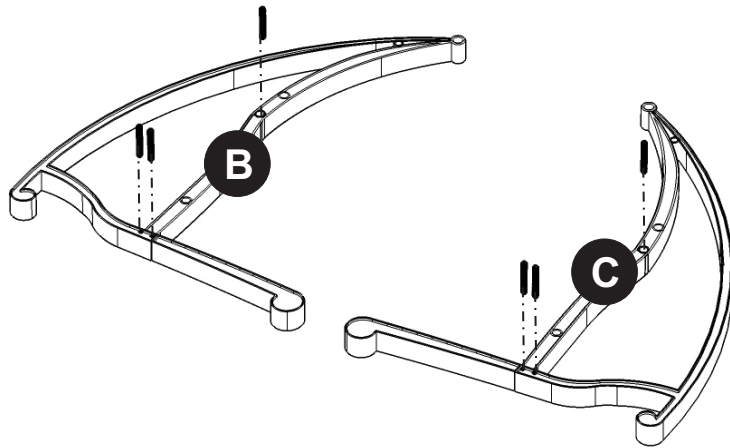

Figure 1



## STEP 2

Attach Arm (B) to Seat (A) with Flat Washers, Spring Washers, Nuts and Nut Caps.  
(See Figure 2)

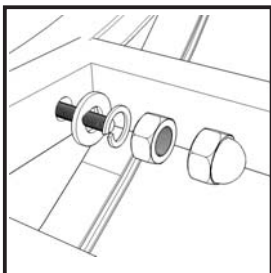
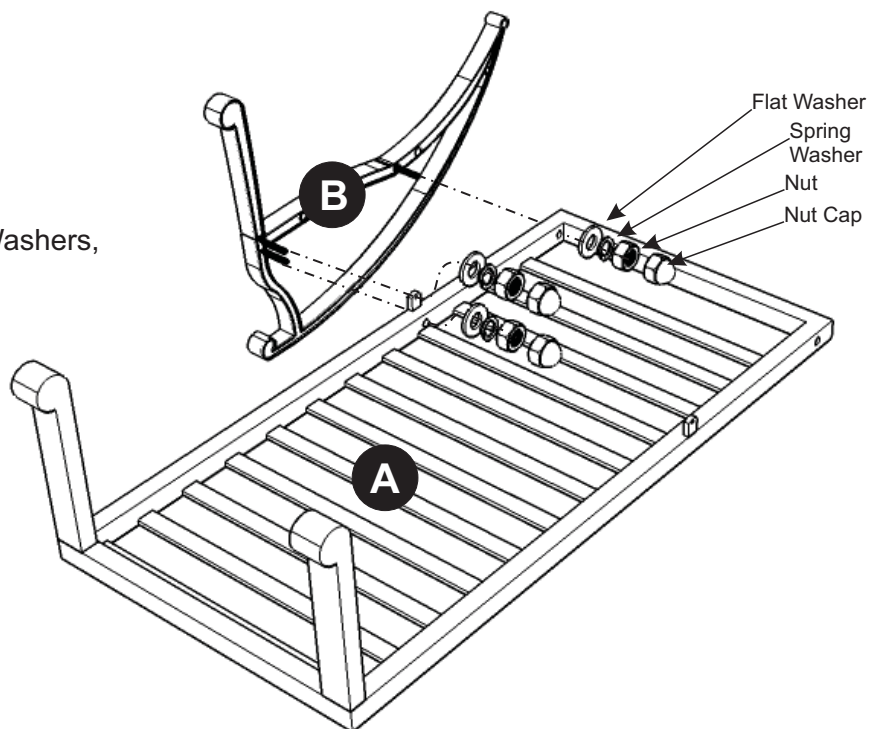

Figure 2



## STEP 3

Place Back Frame (D) into position.  
(See Figure 3)

Attach Arm (C) to Seat (A) with Flat Washers, Spring Washers, Nuts and Nut Caps.

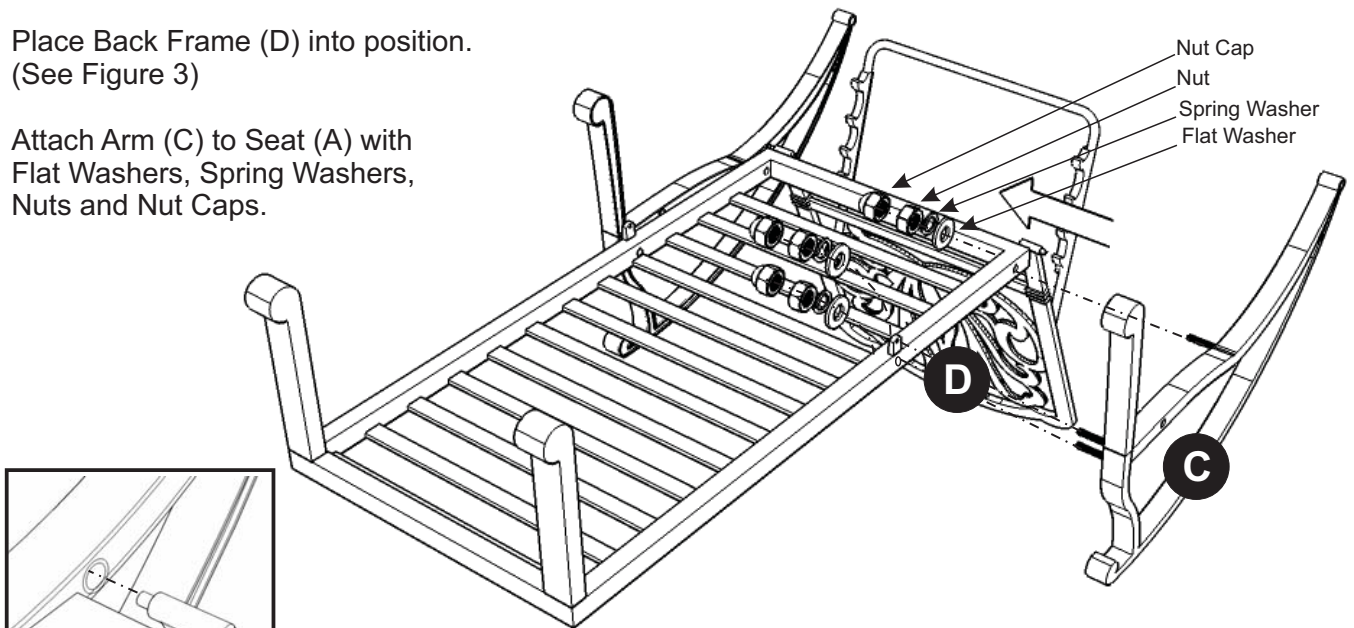
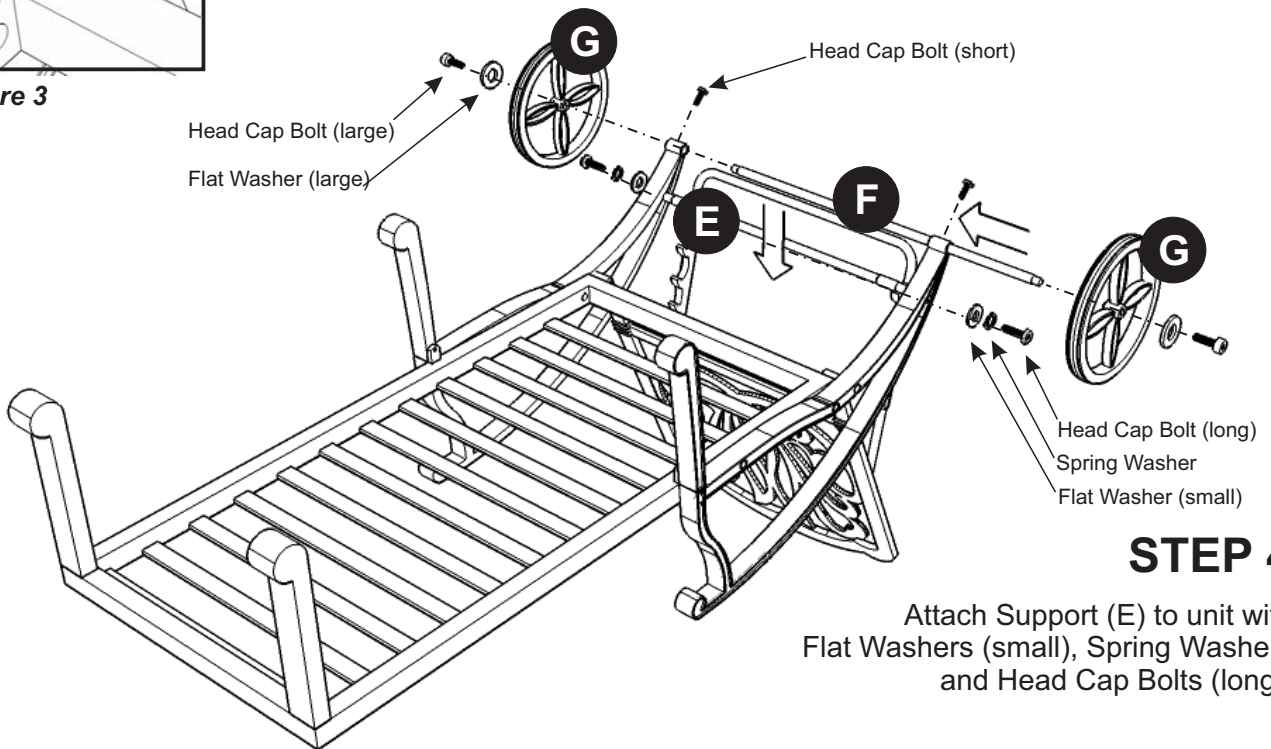

Figure 3



## STEP 4

Attach Support (E) to unit with Flat Washers (small), Spring Washers and Head Cap Bolts (long).

Slide Axle (F) into unit, aligning it in a centered position (left to right).

Lock Axle (F) in place by inserting Head Cap Bolts (short) into the per-drilled holes of unit

Attach Wheels to unit with Flat Washers (large) and Head Cap Bolts (large).  
(See Figure 4)

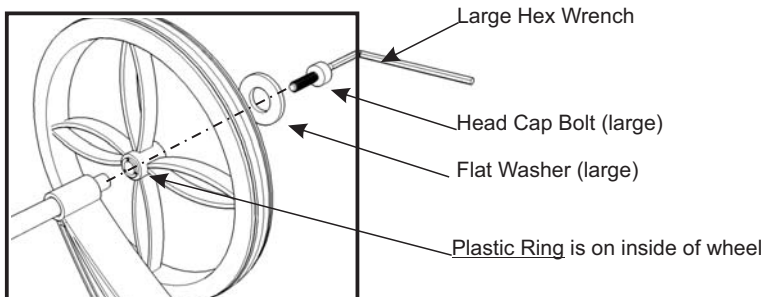
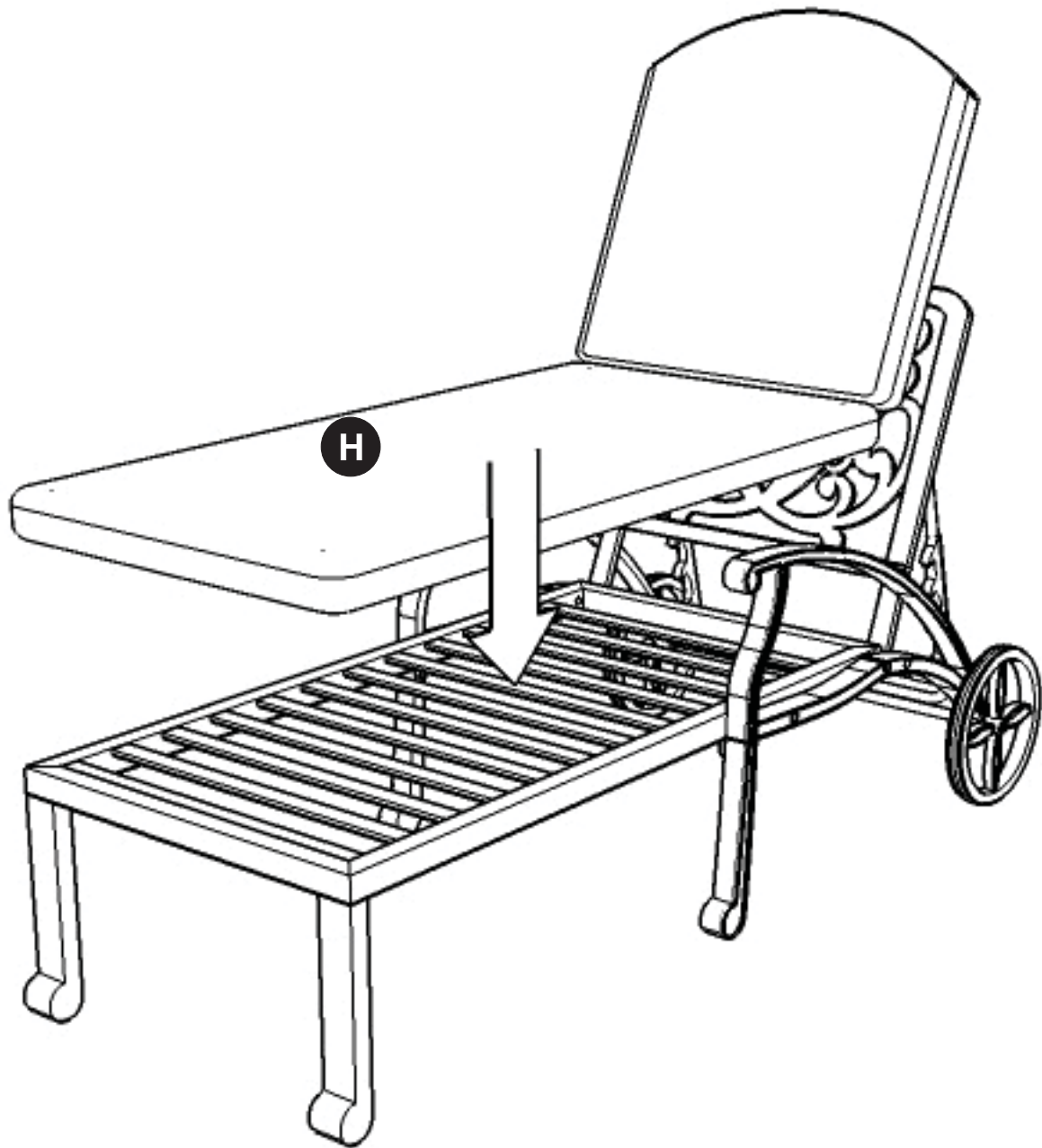

Figure 4



**STEP 5**

Turn the chaise to its' upright position.

Cover the wheel holes with Wheel Caps. (See figure 5)

Place Cushion (H) onto seat.

Use the tie-downs on Cushion (H) to attach to chaise.

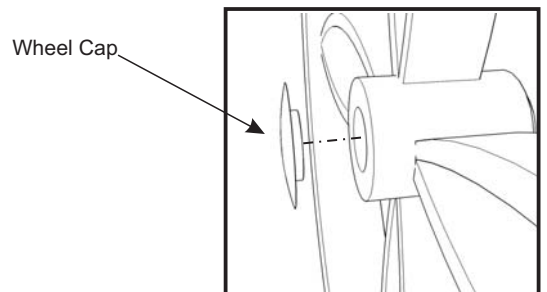

*Figure 5*